

Celerity™ Fiber Optic DVI – User Manual

CT-DFO-DVI

PureLink
digital solutions

Signage • Videowall • Medical

Celerity Fiber Optic DVI cables provide superior video quality and installation ease over traditional copper cable connections up to 1000 feet. They are an efficient installation DVI cable solution supporting long distance source connections to high definition displays in professional video system applications. Combining Celerity's innovation with DVI technology provides AV professionals with a pure fiber optic connection for digital signage, display wall, and medical display monitor systems.

Celerity Technology

Celerity Fiber Optic DVI supports DVI single-link connections via a plenum-rated Celerity Fiber Optic cable that is pre-terminated with a small Celerity fiber optic plug and mini-digital connector at the TX and RX ends. The Celerity Detachable Fiber Optic DVI connector is then attached to the fiber optic plug and to the source and display to complete the connection. No fiber optic terminations are necessary and no separate transmitters and receivers are required. Celerity Fiber Optic DVI connectors feature a unique locking mechanism that slides over the fiber optic cable providing a secure connection.



Designed for Ease of Use

Celerity Fiber Optic DVI is a quick connect, pure fiber digital cable that securely connects digital sources to high definition displays. The thin profile of Celerity Fiber Optic DVI cables improves cable management issues common with multiple display arrays. The 100% fiber optic connection ensures isolation from EMI and RFI issues that can degrade system performance with copper based connections.

Specifications

Supported distance	Up to 1.000 feet
Max resolution supported	WUXGA, 1920 x 1200 and 4K
Supported features	<ul style="list-style-type: none"> • Version 1.2 • DVI-D • HDCP • EDID • Deep Color
Cable jacket	Plenum rated (UL-1651)
Fiber optic cable pull strength	60 pounds
Fiber optic plug dimension	7 x 9 x 25 mm
DVI connector dimension	14.9 x 39.4 x 45.6 mm

Available lengths

10.6m	35f	30.4m	100f
12.2m	40f	48.7m	160f
15.2m	50f	60.9m	200f
18.2m	60f	152.4m	500f
24.3m	80f	304.8m	1000f

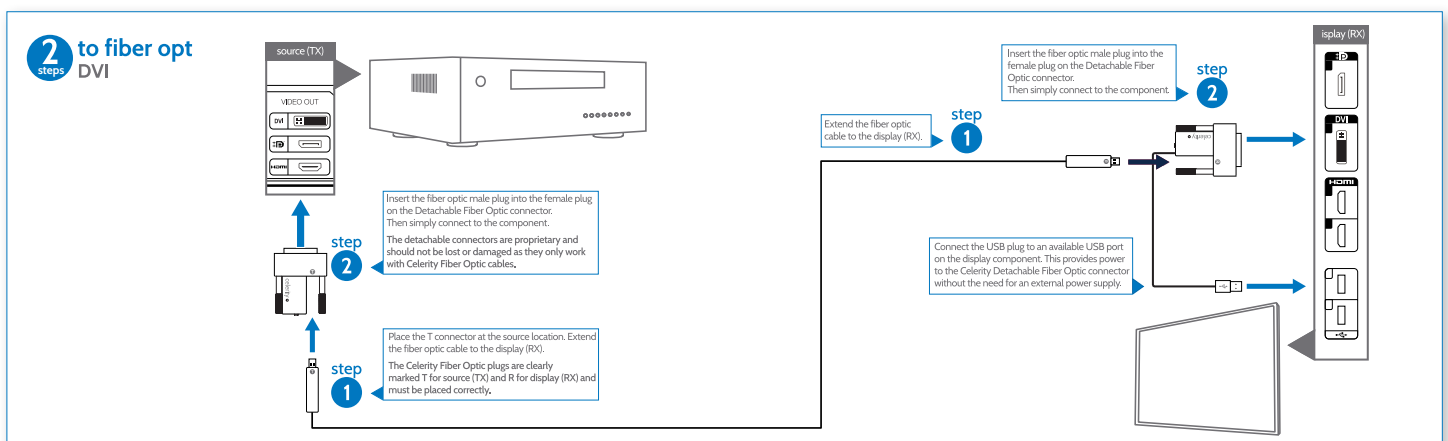

Know - How . Quality . Design .

